



# Groups



Information for Groups staying at the  
Cathedral Guest House

at the

Cathedral of The Isles

Isle of Cumbrae & College of the Holy  
Spirit

**2022-2023 Guide**

# Contact

## Postal Address

The Cathedral Guest House  
The Cathedral of The Isles  
College Street  
Millport  
Isle of Cumbrae  
KA28 0HE

## Telephone

01475 530353

## Email

[office@cathedraloftheisles.org](mailto:office@cathedraloftheisles.org)

## Web

[cathedralguesthouse.co.uk](http://cathedralguesthouse.co.uk)  
This booklet is available on our website

## Social Media

Facebook [www.facebook.com/cathedralguesthouse](http://www.facebook.com/cathedralguesthouse)

Facebook: [facebook.com/cathedraloftheisles](http://facebook.com/cathedraloftheisles)



# Welcome

Thank you for your enquiry in respect of bringing a group to The Cathedral Guest House. We hope the information here is of help to you.

We are a combination of a Visit Scotland 3 Star Guest House and a Christian Retreat House. The Cathedral and attached college buildings were built at the same time in 1851 by the architect William Butterfield. The College was originally built for students of theology in the Scottish Episcopal Church.

The aim of The Cathedral is to create a centre for spiritual development and artistic expression for individuals and groups, and hospitality for guests and for the local community on the Isle of Cumbrae.

We welcome a diverse range of groups to the Cathedral Guest House, including retreat groups, choir groups, residential musical school groups, artistic groups, photography groups, family groups and social groups.

You will find everything you need in start your booking in this pack. Please read it carefully.

To book with us please contact us with guest numbers and dates to check availability, request a booking form and a room allocation form.



# Facilities

The Cathedral accommodation is in 2 main buildings and is set in eight acres of grounds including lawns, woodland as well as the Cathedral itself. It has eighteen bedrooms, a mixture of single, double and twin with 5 rooms with en-suite facilities.

The **South College** houses three reception rooms - the Library, the Common Room and St Brendan. The library and common room are both comfortably furnished with easy chairs and a number of upright cushioned chairs. The South College also houses the Refectory and seven standard bedrooms on the first floor.

The **Refectory** in the South College is where all meals are served.

The **Library** features an open fire and plenty of comfortable seating. It is the main room of the college and houses an extensive collection of theological books which are available to borrow whilst staying with us. The Library can easily accommodate groups of 35 people.

**St Brendan** in the South College can accommodate groups of 10 people and is set-up with a large table and chairs for eight people (the room can accommodate an additional table and chairs for 2-4 people) and a smaller comfortable seating area.

The **North College** has eleven bedrooms - five of which are en-suite. One of the ground floor bedrooms has a separate bathroom equipped for the less able and another has a private lounge attached, which is often allocated to the group leader and used as a common room for the group.

In order to keep our costs low we have to maximize use of the buildings and there may be another group or individual guests visiting at the same time. If you would like exclusive use of the North College or of both colleges please discuss this with us so that you can book the accommodation you need.

In total, we have sleeping accommodation for up to 35 people in 18 bedrooms. For larger groups, we can link up with other establishments on the island to increase capacity.

## The Cathedral itself

We welcome groups to join us in our services or to organise their own, in consultation with the Manager. The Cathedral has its own liturgical life as well as having a strong musical tradition. On Sundays there is a Eucharist at 11a.m. In the summer there is a Concert at 3pm every Sunday. Our Director of Music, Alastair Chisholm, is pleased to help groups in any way when he is available.

## Equipment

There is a television, CD player, DVD player, Digital projector, Overhead projector and screen, and flip chart, in the South College and wireless internet throughout both buildings. There is a further television in the private lounge of Charity in the North College.

**Meals** at the College are from a set menu and are taken in the refectory. Breakfast includes the options of porridge and a full cooked breakfast, lunch is usually soup & sandwiches with fruit & yoghurt and dinner is a 2 or 3 course meal with vegetarian/vegan option if requested. Where guests advise us in advance we are happy to cater for special medical diets.

**Special Diets**—vegetarian, vegan and those that are required for medical reasons only (allergies and intolerances) can be catered for and should be advised when booking.



# History

The Cathedral and College owe their existence to the vision of their patron and founder, the Hon. GF Boyle, later 6th Earl of Glasgow. The College buildings and Cathedral date from 1851 and were designed by the renowned Victorian architect William Butterfield, whose other works include Keble College Oxford, All Saints Margaret Street, London and Melbourne Cathedral.

The Cathedral is the smallest in Britain, seating only 70 people. Despite its size, it is an architectural gem. Beautifully proportioned on the outside, its interior contains fine examples of brightly coloured tiles and richly-coloured **stained glass windows which are hallmarks of Butterfield's design.** The chancel ceiling depicts the variety of wild flowers found on the island.

Today the Cathedral is the place of worship for the local Episcopal congregation, and retains its status as one of the two Cathedrals of the Diocese of Argyll. There is a rich tradition of sacred and classical music, and choirs and groups come from near and far to sing and perform in the Cathedral.



# Cumbrae

For stunning views and peaceful settings the Isle of Cumbrae is second to none. It is a paradise for those who enjoy nature – over 120 species of birds, seals in the bay, porpoises off the shore, polecats, slow worms and rare **orchids can be seen throughout the year. It's the perfect place to forget** about the pressures of life, relax, enjoy the views and just unwind.

With its safe beaches and open spaces, Millport is an attraction for kids of all ages. There are rock pools to explore, indoor and outdoor amusements, toy shops, bikes to hire from three bike hire shops and cafes for food and refreshments. Within the Garrison House, there a number of display cases documenting some of the history of the town.

**Hire a bike on the island or bring one with you, the Island is a biker's** paradise. Take the circular route around the shore and it is almost all flat and just over ten miles. Stop off for refreshments at Fintry Bay or cycle up to the highest point which is 417 feet.

There is an excellent 18 hole golf course and a very fine Bowling Club within the town and both welcome day visitors. There are trails to follow, beaches to explore, hills to climb, wildlife to observe and marvellous views to enjoy. Sea fishing is excellent from the shore on Cumbrae and fly fishing is available in two well stocked lochs.

The town of Millport retains much of the charm of the heyday of seaside resorts in the Victorian era and the view from the prom and nothing short of stunning.

**You'll find more information on the island's own website: [millport.org](http://millport.org)**

---

# Getting here

The Isle of Cumbrae is easily reached from Largs by making a short 10-minute ferry trip. There are excellent transport connections to Largs from Glasgow and its environs.

## By road, bus, rail and air to Largs

Largs is around an hour by road, rail, car or bus from Glasgow city centre, Glasgow International and Glasgow Prestwick airports.

**By road** - From Glasgow city centre, take the M8 eastbound (Greenock). After Paisley and Glasgow International airport, exit at J27 onto the A737 Kilwinning. At the Lochwinnoch roundabout turn right onto the A760 to Kilbirnie. Turn right at Kilbirnie Radio City/Tesco roundabout and continue on the A760. Turn right at the traffic lights at the entrance to Largs onto the A78, following the signs to the Cumbrae ferry (Pier Postcode KA30 8BG).

**By bus** - The First Bus 'Clyde Coaster (901)' and McGills 'Glasgow 901' bus both leave Glasgow Buchanan Bus station to Largs via Greenock every half-hour. Scottish Citylink website – [www.citylink.co.uk](http://www.citylink.co.uk).

**By rail** - There is an hourly service to Largs departing to and from Glasgow Central station - [www.rail.co.uk](http://www.rail.co.uk) or telephone 0871 244 1545

**By air** - There is no direct rail service from Glasgow International to Largs. Rail users should change at Paisley Central and use the 10-minute bus connection. Rail tickets include the cost of the bus transfer if requested to Glasgow International. There are 3 direct bus services a day to and from the airport. Otherwise bus users should take a bus to Greenock, and then take a McGills or FirstBus service from Greenock to Largs.

Glasgow Prestwick is served by an hourly service to Largs (Stagecoach 585 'Clyde Coaster'), and an hourly rail service (change at Kilwinning). Rail users travel half price to anywhere in Scotland from Prestwick Airport on production of a relevant boarding pass.

**From Largs to Millport, Isle of Cumbrae** - Take the 10-minute Caledonian MacBrayne





ferry crossing from Largs Pier (Postcode KA30 8BG) to Cumbrae Slip by car or foot. The first ferry departs Largs at 0645 Monday to Saturday, 0915 Sunday. Half-hourly. The last ferry is 2015. [The first ferry departs Cumbrae Slip at 0700 Monday to Saturday, 0930 Sunday. Half-hourly. The last ferry is 2030.] There are 2 additional evening services on Fridays during the summer (BST only, bookable). For more information on ferry times, see [www.calmac.co.uk](http://www.calmac.co.uk) – telephone 01475 650100

**Then by bus** - There is a connecting bus for the short journey to Millport, scheduled to **coincide with ferry times. Ask for ‘The Cathedral’ and alight at College Street. The Cathedral entrance is on College Street.** (This entrance is for those arriving by foot only.) Alternatively, ask to be put off at Mount Stuart Street and follow the signs to the Cathedral. This avoids the steps and is easier for those pulling a case.

**Or by car**

Keep going beyond the Cathedral gates on College Street and there is a concealed entrance in the wall on the right a short way up.

**Or by taxi**

To be met at the ferry by taxi telephone 01475 530666.



# Room Details

Our usual practice is for groups to allocate people to their rooms. Please use the information here to help you plan who will go where. Complete and return the separate room allocation form as soon as you are able and ideally at least 6 weeks prior to your stay. Thank you.

|                                                                                                                                                                                                                                                                                  | Room Type                            | Facilities                          | Information                                              |
|----------------------------------------------------------------------------------------------------------------------------------------------------------------------------------------------------------------------------------------------------------------------------------|--------------------------------------|-------------------------------------|----------------------------------------------------------|
| <b>SOUTH COLLEGE</b>                                                                                                                                                                                                                                                             |                                      |                                     |                                                          |
| <i>This is the main building, with refectory, common room, library and St Brendan. It connects to the cathedral. All rooms have shared bathrooms and are on the first floor.</i>                                                                                                 |                                      |                                     |                                                          |
| St Serf                                                                                                                                                                                                                                                                          | Twin                                 | <i>Sink in room</i>                 |                                                          |
| St Mungo                                                                                                                                                                                                                                                                         | Double                               | <i>Sink in room</i>                 |                                                          |
| St Patrick                                                                                                                                                                                                                                                                       | Double + Single                      | <i>Sink in room</i>                 |                                                          |
| St Ninian                                                                                                                                                                                                                                                                        | Twin                                 | <i>Sink in room</i>                 |                                                          |
| St Adamnan                                                                                                                                                                                                                                                                       | Twin                                 | <i>Sink in room</i>                 |                                                          |
| St Bride                                                                                                                                                                                                                                                                         | Queen Single                         | <i>Sink in room</i>                 |                                                          |
| St Maura & Baia                                                                                                                                                                                                                                                                  | Single or Twin                       |                                     |                                                          |
| <b>NORTH COLLEGE</b>                                                                                                                                                                                                                                                             |                                      |                                     |                                                          |
| <i>This is a separate building with a mix on en-suite and shared bathrooms. Faith, Hope and Charity are ground floor rooms, the remainder are on the first floor. Charity has a large private lounge, that is often used by the leader when a group books for a led retreat.</i> |                                      |                                     |                                                          |
| Faith                                                                                                                                                                                                                                                                            | Double & double/<br>single bunk beds | <i>En-Suite Shower</i>              | <i>Ground Floor</i>                                      |
| Hope                                                                                                                                                                                                                                                                             | Twin                                 | <i>Accessible Bathroom opposite</i> | <i>Ground Floor Suitable for limited mobility Guests</i> |
| Charity                                                                                                                                                                                                                                                                          | Double                               | <i>En-Suite Bathroom</i>            | <i>Ground Floor</i>                                      |
|                                                                                                                                                                                                                                                                                  |                                      |                                     |                                                          |
| Fortitude                                                                                                                                                                                                                                                                        | Double                               | <i>En-Suite Shower</i>              | <i>Room for folding bed</i>                              |
| Joy                                                                                                                                                                                                                                                                              | Single                               | <i>Sink in room</i>                 |                                                          |
| Gentleness                                                                                                                                                                                                                                                                       | Single or Twin                       | <i>Sink in room</i>                 |                                                          |
| Faithfulness                                                                                                                                                                                                                                                                     | Single                               | <i>Sink in room</i>                 |                                                          |
| Peace                                                                                                                                                                                                                                                                            | Double                               | <i>En-Suite Shower</i>              |                                                          |
| Patience                                                                                                                                                                                                                                                                         | Single                               | <i>Sink in room</i>                 |                                                          |
| Goodness                                                                                                                                                                                                                                                                         | Double                               | <i>Sink in room</i>                 |                                                          |
| Kindness                                                                                                                                                                                                                                                                         | Twin                                 | <i>En-Suite Bathroom</i>            |                                                          |

# Day Retreats

We also accept groups for day retreats, events or simply get togethers, the day can be customised for your specific requirements.

You can book the use of our meeting rooms, the two main ones suitable for this is St Brendan and the Library. St Brendan can accommodate 8-12 people, and the Library can accommodate up to 35 people. The common room in the South College is not suitable for separate booking as it is also an access route to the Library (the Library has 2 entrances/exits).

If you require a full day, then the following can be provided

Tea/Coffee on arrival

Mid-morning tea/coffee

Lunch

Afternoon tea/coffee

Dinner (dinner is served at 18:30, the last ferry leaving the island leaves at 20:30).

Recent day events have included

Example 1 full day, no dinner, St Brendan, Group size 8 people

Guests arriving 09:00

Arrival Tea/Coffee

Mid-morning tea/coffee, biscuits and pastries

Lunch—2 course lunch

Afternoon tea/coffee, cakes

Guests leaving around 16:30

Example 2—Part day—Library—Group size 25 people

Guests arriving 11:00

Arrival tea/coffee

Lunch—2 courses

Guests leaving around 15:00

Rates are negotiable dependant upon your exact requirements, please contact us to discuss your requirements ([office@cathedraloftheisles.org](mailto:office@cathedraloftheisles.org) or 01475 530 353). As a gauge to costs, groups who are staying with us pay £10 for a single course lunch, a day group booking will incur additional charges for tea/coffee and room hire (this may be simply folded into a per person charge). Costs depend upon your exact requirements. A 2 course lunch (£15) could be replaced with a 3 course dinner served at mid-day if required.

# Tariff 2022

## Accommodation Charges (per room):\*

| Room Type                                              | Room Price Per Night | En-Suite Type       |
|--------------------------------------------------------|----------------------|---------------------|
| Family Room (1)                                        | £160                 | Shower              |
| Double En-Suite with private lounge (1)                | £95                  | Bathroom            |
| Double En-suite (2)                                    | £95                  | Shower              |
| Twin En-suite (1)                                      | £95                  | Bathroom            |
| Double & Single Standard (1)                           | £120                 |                     |
| Double Standard (2)                                    | £85                  |                     |
| Twin Standard (3)                                      | £85                  |                     |
| Twin Standard—Ground Floor (1)                         | £85                  | Accessible Wet Room |
| Single Standard (6) * 2 can be converted to twin rooms | £60                  |                     |

Note, the private lounge cannot be locked.  
All rates include VAT

## Meal costs (as part of a group booking including accommodation)\*

Lunch — £10 per person  
Dinner - 2 course £20 per person  
Dinner - 3 course £25 per person

Group deposit requirements are 1) a non-returnable deposit of £500 to secure the booking 2) half the final amount due 3 months prior to arrival 3) Full payment 1 month before arrival 4) Final bill and any adjustments on day of departure.

There are two types of group booking: Exclusive and non-exclusive. Exclusive grants use of the entire college regardless of numbers staying and no other guests will be allowed to book. Please contact the manager for the Exclusive only tariff rate. A group is 12 or more paying guests staying over the same period.

For groups staying and having meals at the Cathedral Guest House, we can accommodate additional guests (non-residential) during meal times if required and requested.

\*Rates are subject to change and may be slightly higher for 2023.

# Gallery

Cathedral and South College



South College



North College



North College & Labyrinth



Cloisters & South College



Cathedral



# Gallery

Cloisters—Reception Area



Cloisters



Refectory



# Gallery

South College Common Room



South College Library



South College Library



South College Library



St Brendan



St Brendan



# Gallery

Faith—Family Rooms Sleeps 4



Faith—Family Room Sleeps 4



Charity—Double En-suite



Fortitude—Double En-suite



Goodness—Double Standard



St Ninian—Twin Standard





# Floor Plans

Entire Complex Ground Floor

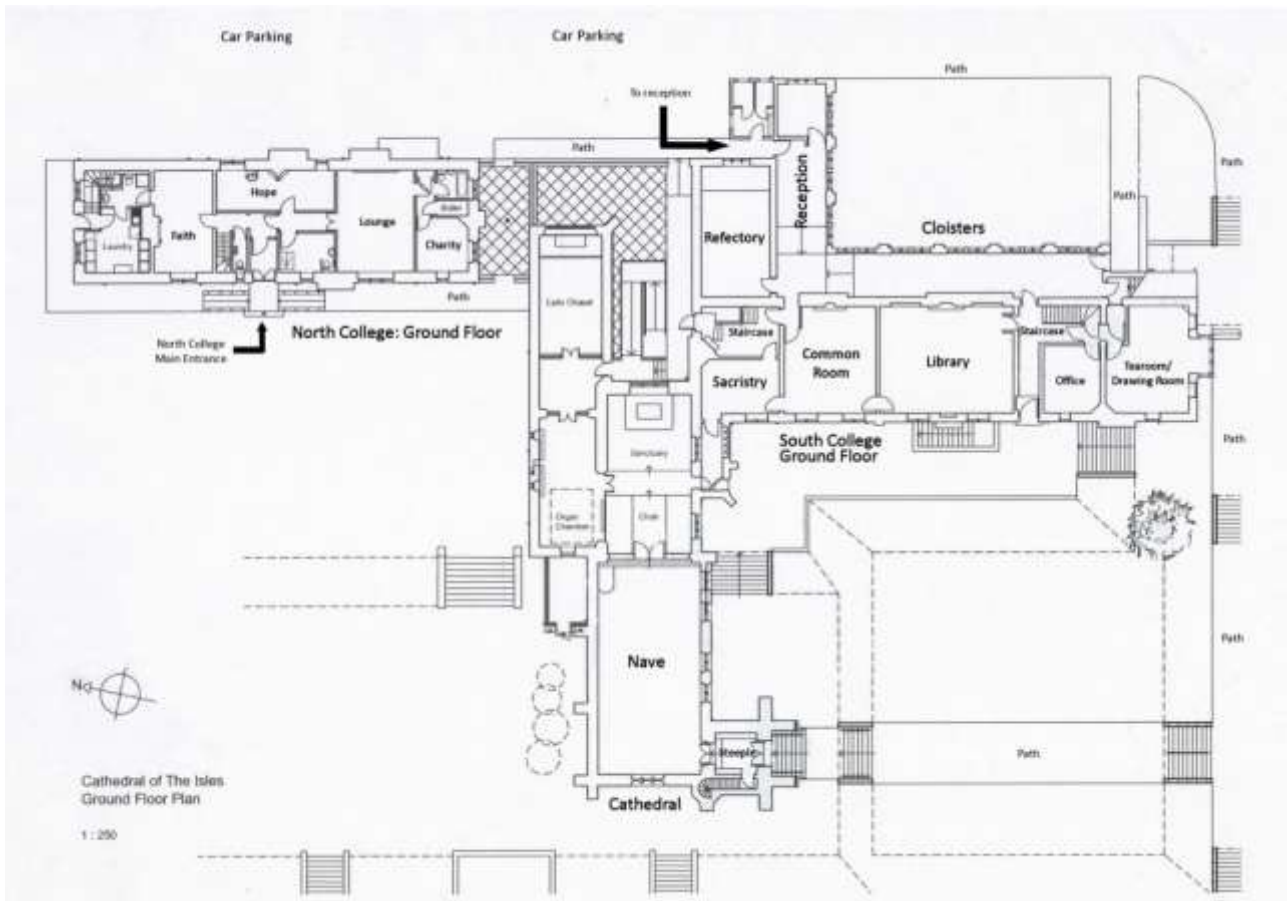

# Floor Plans

Entire Complex First Floor

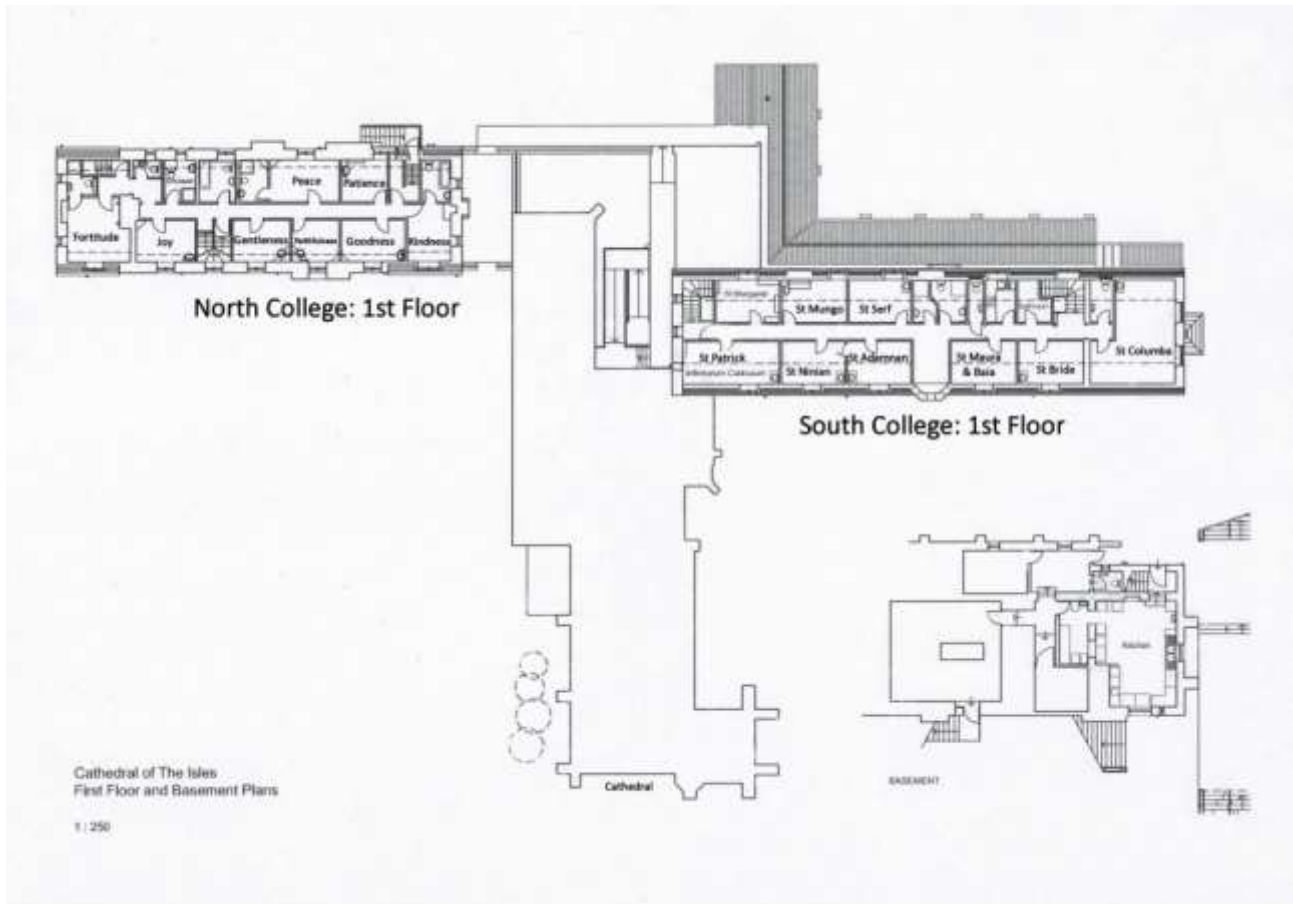

# Floor Plans

North College

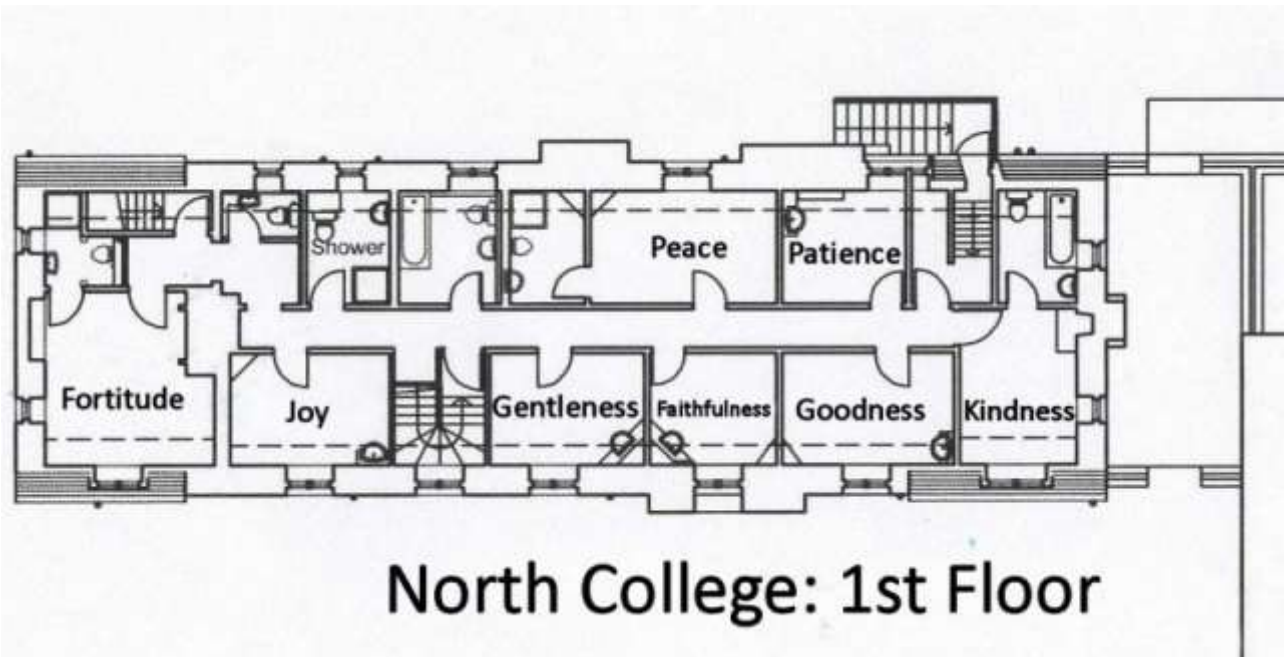
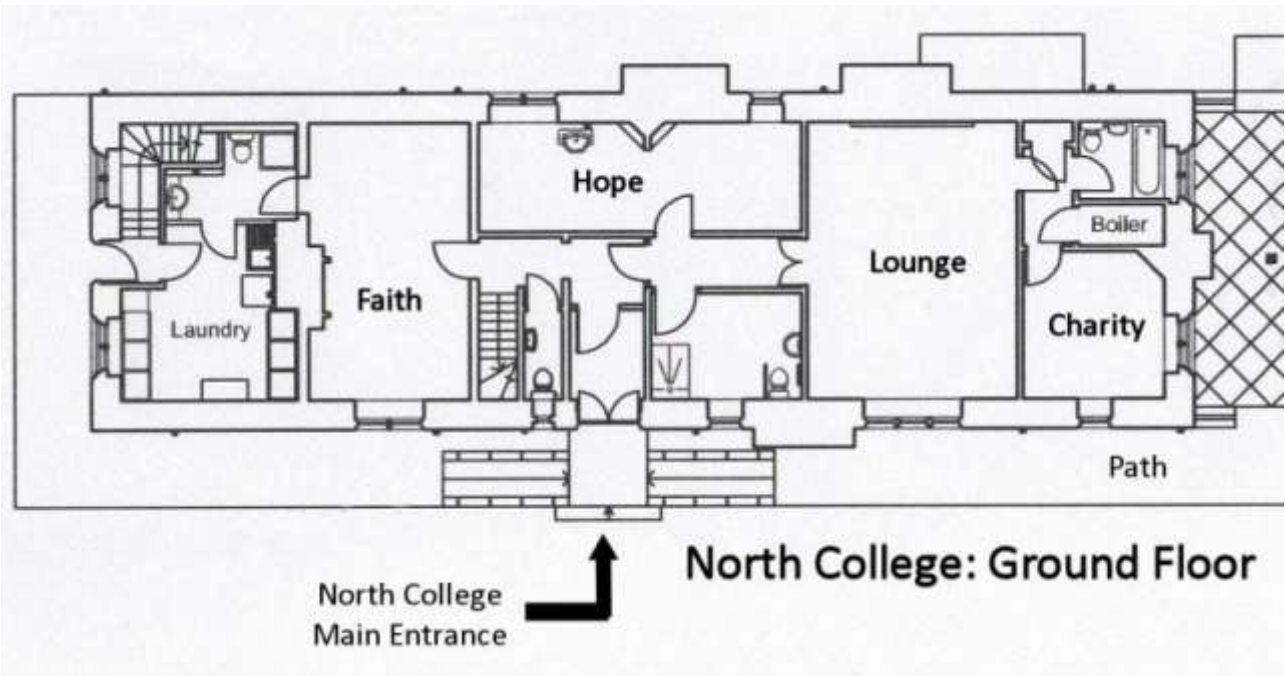

# Floor Plans

South College

